



GP360D MOBILE GROUNDHOG WELFARE UNIT

The Groundhog mobile GP360 is designed to ensure that not only do contractors on transient sites meet with current HSE regulations, but that they also have the best possible facilities for their operatives.

The Groundhog GP360 can be towed by the client's own vehicles not only to and from site, but also relocated on site giving the flexibility of progressing with the job.

The Health and Safety at Work Act for Welfare Units

Regulation 20	Sanitary Conveniences	Complies	✓
Regulation 21	Washing Facilities	Complies	✓
Regulation 22	Provision for Fresh Drinking Water	Complies	✓
Regulation 23	Provision for Drying Clothing	Complies	✓
Regulation 24	Facilities for Changing Clothing	Complies	✓
Regulation 25	Facilities for Rest & to Eat Meals	Complies	✓

HSE NOTE: Failure to comply with the above regulations could result in the closure of the site.

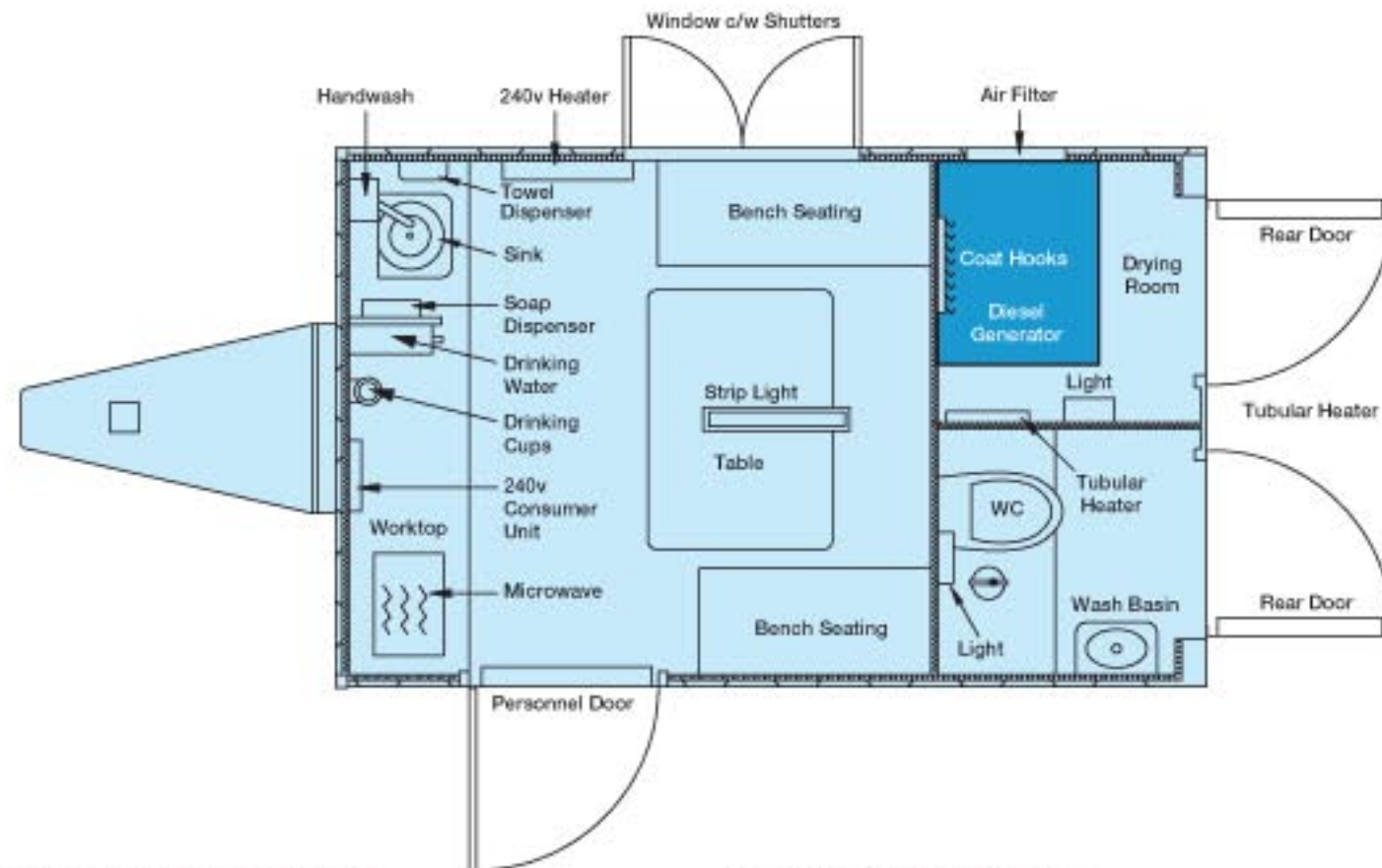

Standard Equipment

- Unique Groundhog patented lowering axle mechanism
- Lined and insulated interior
- Large wrist to elbow wash basin
- Soap and paper towel dispensers
- Clean drinking water facility
- Electric lighting, microwave and warm hand wash
- Seating and table for up to 6 operatives
- Facility for storage of wet clothing
- 6 kVA silenced diesel generator
- Recirculating toilet and washbasin

Benefits

- Complies with HSE Regulations for welfare on site
- Flexibility of relocating with own vehicles
- Built-in power
- Groundhog patented lowering mechanism
- One-person operation
- Pleasant rest environment

Technical Details

Gross trailer weight	1800 Kg
Net weight	1740 Kg
Diesel tank capacity	48 Litres
Fresh water	25 Litres
Waste water	25 Litres
Fresh drinking water	20 Litres
Overall Length (inc towbar)	5.16 m
Length	3.60 m
Width	2.30 m
Height	2.40 m

Weights and dimensions may vary dependent on model and options fitted.

groundhog